

by **PAT M. GOODOVER**
 President and General Manager

250 W . . . **KXLL** Missoula, Montana



FIG. 1. Shown above is the transmitter building of KXLL which is situated about 200 feet from a river. The antenna tower shown at rear of the building is located at river's edge with half its ground system buried under water.

KXLL, located in Missoula, Montana, is one of the most important outlets of a chain of eight affiliated radio stations known as the Pacific Northwest Broadcasters which serves over two and a half million people in Montana, Oregon, and Washington.

Because of its strategic location in the center of the Pacific Northwest chain, KXLL is frequently called upon to switch back and forth between the stations in Montana and its affiliated members in Washington, and Oregon. At times it originates its own shows and it feeds both east and west legs of the PNB circuit.

To accommodate the various functions required for network operation, KXLL has had to modify its basic RCA equipment. A three inch panel, which serves as a base for the RCA Console, houses the various controls and relays which permit special purpose switching between the legs of the network.

The transmitter building is situated on a plot of ground on the banks of the Clark Fork River. One half of the station's ground system is perpetually under water. The antenna tower is located on the edge of the river.

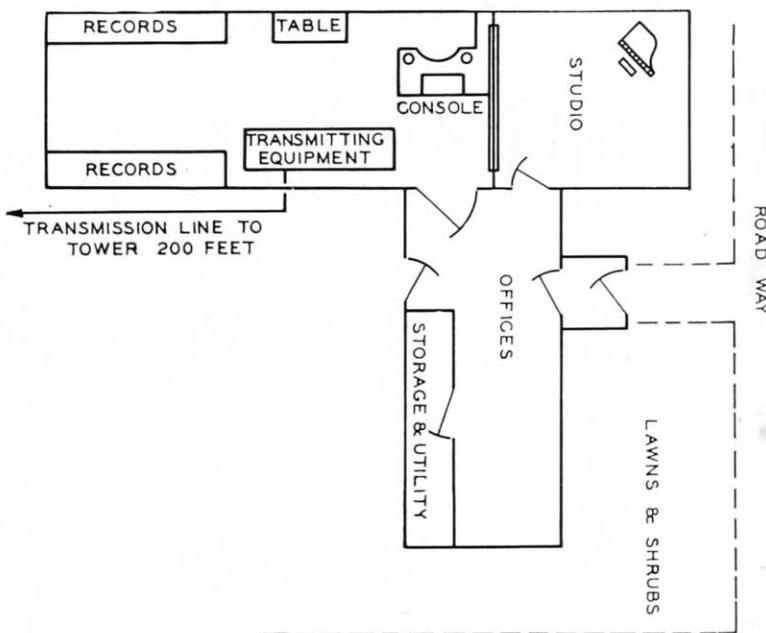

FIG. 2. Photo above shows a simple floor plan of Station KXLL. As can be seen in the plan, the operator at the control position has a good view of the studio and other office facilities.



FIG. 3. The control console and transmitter are so placed that the operator can easily monitor all the equipment.